

# S & S MODELS

## 1/72 SCALE M1 SHERMAN DOZER INSTRUCTIONS

THE M1 DOZER BLADE ATTACHMENT WAS DEVELOPED DURING WW2 TO ENABLE THE TANK UNITS TO CLEAR ROADS AND SMALL ENGINEERING TASKS AS ALTHOUGH MOST ARMIES HAD CIVILIAN TYPE BULLDOZERS THEY WERE VERY SLOW AND COULD NOT KEEP UP WITH THE ADVANCES BY ARMoured UNITS.

THIS DOZER SHOULD FIT ALL 72 SCALE SHERMANS WITH VVSS SUSPENSION.

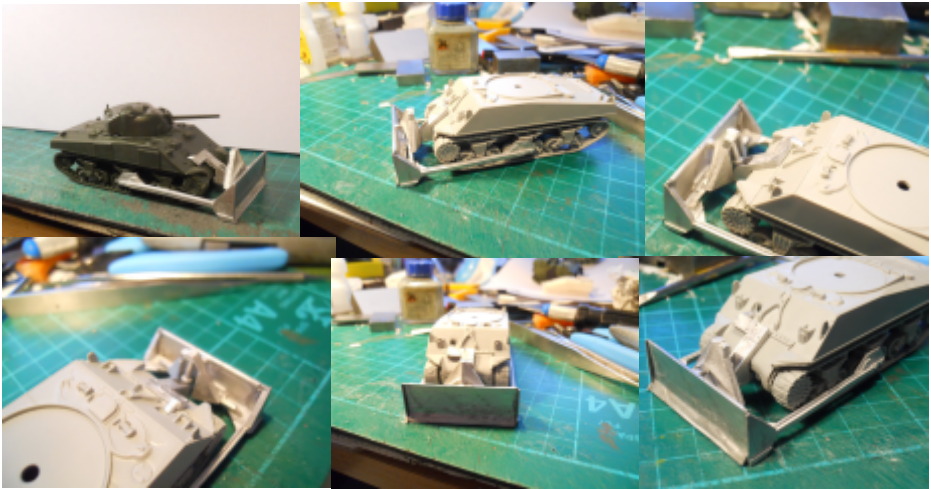

### **SAFETY:-**

DO NOT ALLOW ANYONE TO EAT OR CHEW ANY PART OF THIS MODEL ALWAYS WASH HANDS AFTER HANDLING ANY PARTS.

### **S&S MODELS**

22 BRIAR CLOSE  
BURNHAM ON SEA  
SOMERSET U.K.  
TA8 1HU

**THE M1 DOZER WAS ALSO FITTED  
TO THE M3 LEE AS WELL**

MORE PICS HERE:-

<http://s513.photobucket.com/user/sandsmodels/library/WW2%2020mm%20conversion%20kits?sort=3&page=2>

WEBSHOP:-

<http://sandsmodels.com/>